

**LEGEND**

- ✳ Traffic Light
- ◆ Entrance
- ♿ Disabilities Entrance
- 🚏 Shuttle Stops
- ? Welcome Center
- ✚ Emergency



*\*Map not to scale*



**Parking is available in the West Visitor Parking garage.**

## **Driving Directions:**

### **From I-75**

- Take exit 384 to Gainesville/Archer Road
- Head East on Archer Road for approximately 3 miles
- Turn left at Center Drive traffic light (just after Gale Lemerand Dr.)
- UF Dental Tower will be on the right

## **Parking:**

### **For visitors without a Handicapped parking sticker:**

- After turning onto Center Drive continue straight.
- Turn left at the first stop sign (Mowry Rd).
- Approximately 50 yards up, turn left and the entrance for the West Visitor garage will become visible on your left.
- Enter garage and take a ticket to lift gate. **You will be provided with a complimentary voucher from the study staff if you park in this garage. Please ask a member of the study team for a voucher at the conclusion of your visit.**
- Park and take stairs or elevator down to first floor (marked with a star).
- Follow walking directions below.

### **For visitors with a Handicapped parking sticker:**

- After turning onto Center Drive, turn right into parking lot located outside of West Dental tower entrance.
- Park in designated spaces and following walking directions below.

## **Walking Directions:**

- Cross Center Drive at crosswalk and continue straight (for those parked in West Garage only).
- Enter Dental Tower through doors located under blue awning marked **West Entrance**.
- Refer to the additional map for interior directions to our clinic space in the Speech and Hearing Center on the second floor of the Dental Tower. **Once at the Speech and Hearing Center, please inform the front desk that you have an appointment for the Plowman Research Study.**

# Shands at the University of Florida

1600 SW Archer Road, Gainesville, FL 32610

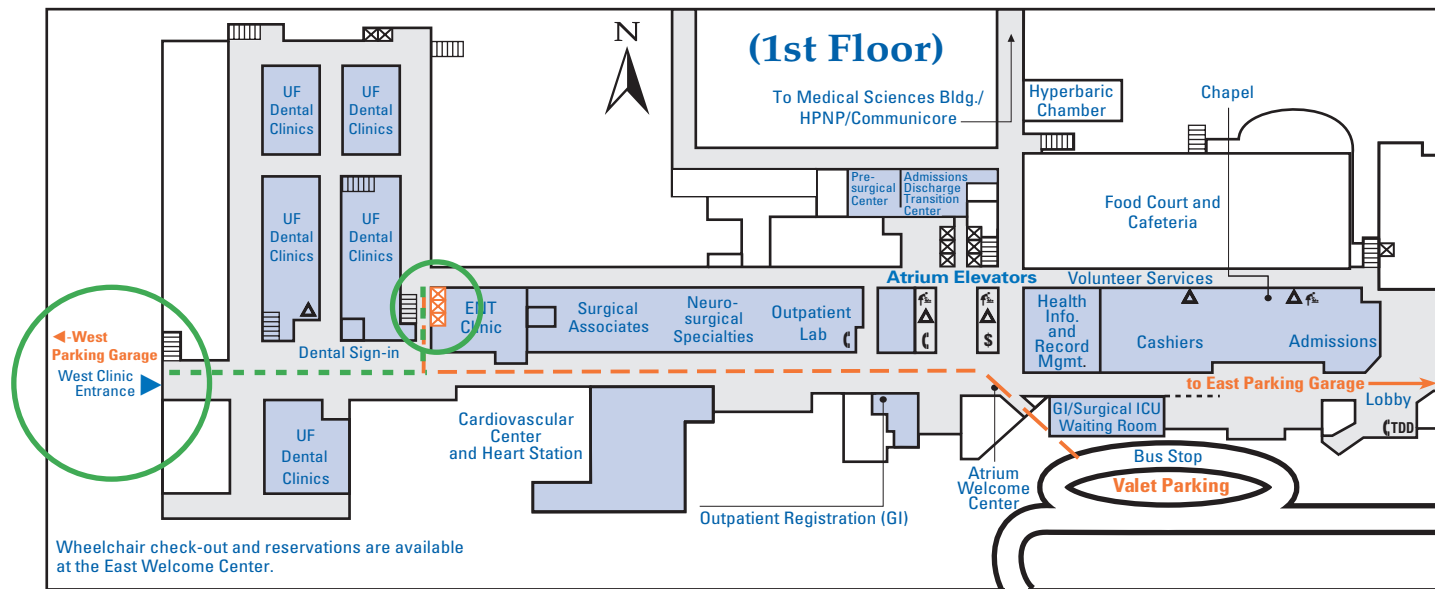
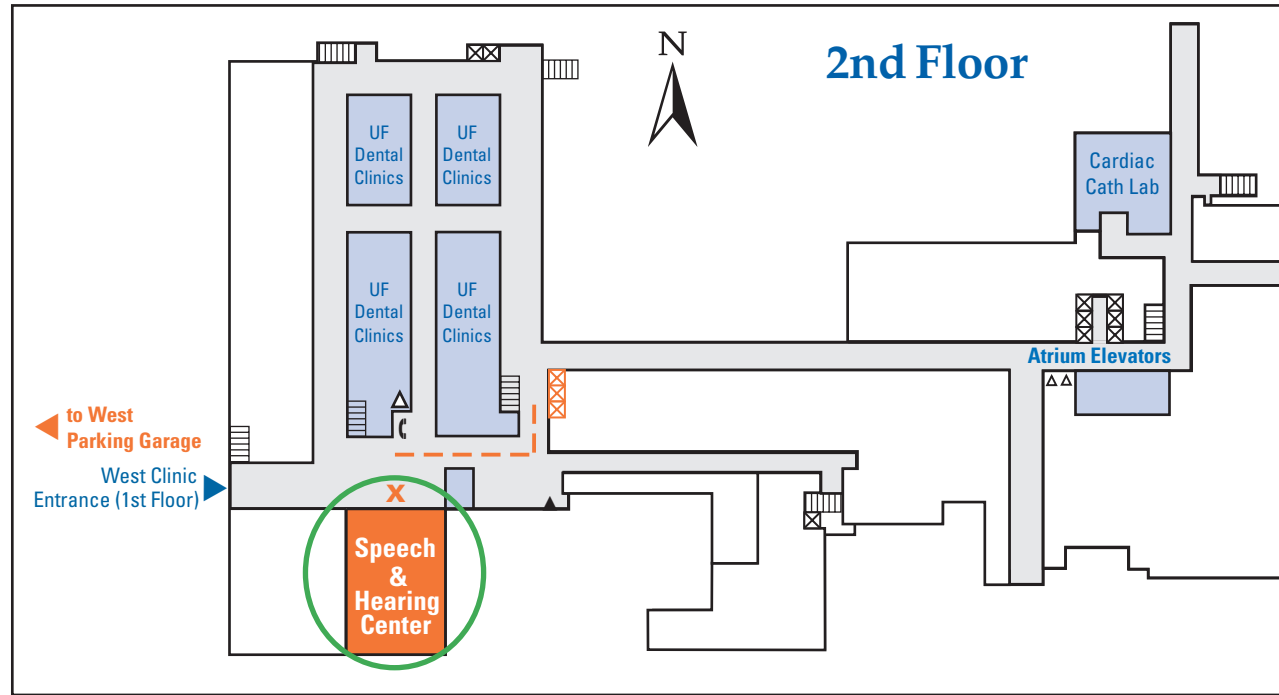

← Archer Road →

**Symbol Key-** ☎ Phones   🍼 Diaper Changing Station   △ Restrooms   \$ ATM   X Clinic Entrance   ☒ Elevators